

REFURBISHED

UNIT 1

PREMIER PARK

PARK ROYAL NW10 7NZ
📍 ///ENGINE.DARE.BANANA



TO LET

MODERN INDUSTRIAL / WAREHOUSE UNIT
IN PRIME PARK ROYAL LOCATION

27,678 SQ FT (2,571 SQ M)

SUSTAINABILITY

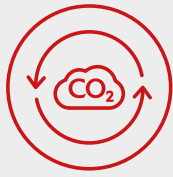

Net zero carbon



EPC A+



172 kWp PV array



Cycle parking



6 EV charging points



Shower



Welfare external break out area



Smart sensors

SPECIFICATION

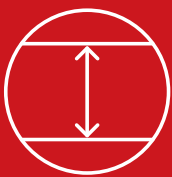

8m clear height



3 level access loading doors



245 kVA power



Fully fitted offices with VRF heating/cooling system



Dedicated yard space



End of terrace unit



17 car parking spaces



24 hour access and use



Estate CCTV and 24 hour manned gatehouse



LED lighting throughout

SITE PLAN

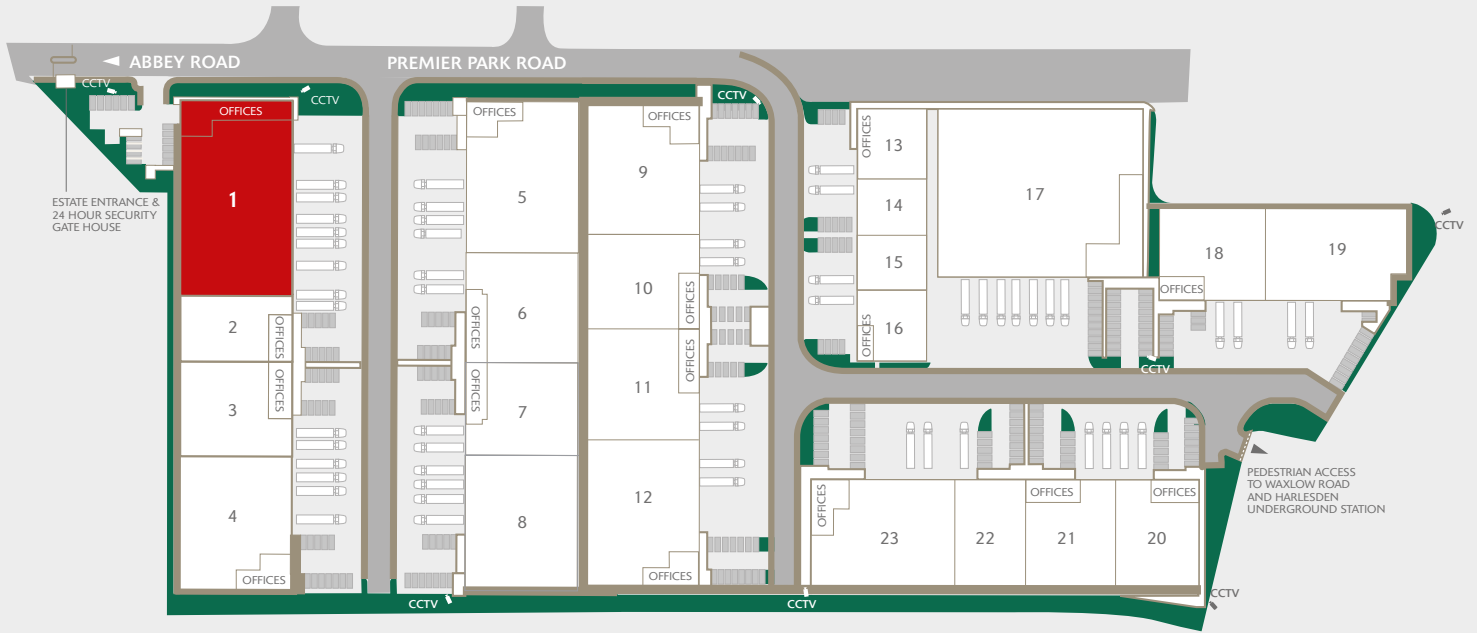

ACCOMMODATION

	sq ft	sq m
Warehouse	23,029	2,139
Ground floor ancillary	1,076	100
First floor ancillary	3,573	332
TOTAL	27,678	2,571

(All areas are approximate and measured on a Gross External basis)



✓ **Premier Park** is an established, well managed estate development in the heart of Park Royal

✓ **Energy efficient** unit with low maintenance costs

📍 **Excellent access** to A406 North Circular Road (400m to north), Central London via A40 Western Avenue, the M1 and M40 motorways

★ **Well known occupiers** on the estate include DHL, Kolak Foods, Royal Mail, Japan Centre, RD Content and Brakes

👥 **A labour pool** of over six million people within a 30 minute drive



DISTANCES

A406 NORTH CIRCULAR	0.2 miles
HARLESDEN ☺	0.6 miles
STONEBRIDGE PARK ☺	0.9 miles
A40 WESTERN AVENUE	1.0 mile
ALPERTON ☺	1.6 miles
HANGER LANE ☺	1.6 miles
PARK ROYAL ☺	2.0 miles
NORTH ACTON ☺	2.1 miles
M1 (JUNCTION 1)	3.0 miles
M4 (JUNCTION 1)	4.7 miles
CENTRAL LONDON	7.0 miles
M40 (JUNCTION 1)	10.1 miles
M25 (JUNCTION 16)	12.9 miles

Source: Google maps

ABOUT SEGRO

SEGRO is a UK Real Estate Investment Trust (REIT), listed on the London Stock Exchange and Euronext Paris, and is a leading owner, manager and developer of modern warehouses and industrial property.

It owns or manages 10.4 million square metres of space (112 million square feet) valued at £20.7 billion serving customers from a wide range of industry sectors. Its properties are located in and around major cities and at key transportation hubs in the UK and in seven other European countries.

See SEGRO.com for further information.

The content of this document is believed to be correct at the date of Publication. However, the Company and its retained agents accept no responsibility or liability for (or make any representation, statement or expression of opinion or warranty, express or implied, with respect to), the accuracy or completeness of the content of this document. If you would like to unsubscribe from future mailings, please contact marcomms@SEGRO.com. 03/25.

FOR MORE INFORMATION, PLEASE VISIT
SEGRO.COM/PREMIERPARK

Or, alternatively, please contact the joint agents:



Katy Kenealy
020 3369 2321
James Miller
020 3369 2335



Alex Kington
020 3369 2358
Callum Moloney
020 3369 2374



Stan Gibson
020 3369 0895
YC Lau
020 3369 2243
Patrick Rosso
020 3369 2261

SEGRO

SEGRO.com